

**AN ORDINANCE REZONING A 10 ACRE PARCEL LYING IN SECTION 13,
TOWNSHIP 7 SOUTH, RANGE 5 WEST, OFF OF MILL ROAD, CARRABELLE,
FRANKLIN COUNTY, FLORIDA FROM A-2 AGRICULTURE TO R-1 SINGLE
FAMILY RESIDENTIAL.**

**ORDINANCE 2005-06
FRANKLIN COUNTY, FLORIDA**

WHEREAS, the Board of County Commissioners of Franklin County, Florida has received a recommendation from the Franklin County Planning and Zoning Commission for rezoning certain private real property, and

WHEREAS, the Board of County Commissioners of Franklin County has conducted a public hearing with due public notice,

NOW, THEREFORE, BE IT ORDAINED BY THE FRANKLIN COUNTY BOARD OF COUNTY COMMISSIONERS that:

A 10 acre parcel lying in Section 13, Township 7 South, Range 5 West, off of Mill Road, Carrabelle, Franklin County, Florida is rezoned from A-2 Agricultural to R-1 Single Family Residential.

Legal description and map attached as Exhibit A.

This Ordinance adopted this 1st day of March, 2005, in a regular meeting of the Franklin County Board of County Commissioners after giving notice of intent to adopt it as a rezoning of less than 5% of the County. This Ordinance shall take effect when notice of receipt of a certified copy of same is returned from the Florida Secretary of State



ATTEST:

Marcia M. Johnson
Marcia M. Johnson, Clerk

THE FRANKLIN COUNTY BOARD
OF COUNTY COMMISSIONERS

BY:

Cheryl Sanders
Cheryl Sanders, Chairman

Commence at the Southwest corner of Section 13, Township 7 South, Range 5 West, Franklin County, Florida and run North 1828.93 feet, thence run North 89 degrees 59 minutes 22 seconds East 2199.40 feet, thence run South 00 degrees 01 minutes 36 seconds West 487.98 feet to a point lying on the Northeasterly right-of-way boundary of a county graded dirt road, thence run South 58 degrees 03 minutes 12 seconds East along said right-of-way boundary 546.74 feet to a concrete monument (marked #4261), thence leaving said right-of-way boundary run North 15 degrees 42 minutes 24 seconds East 684.89 feet to an iron rod and cap (marked #7160) marking the POINT OF BEGINNING. From said POINT OF BEGINNING run North 15 degrees 42 minutes 24 seconds East 540.90 feet to a concrete monument (marked #4261), thence run South 68 degrees 43 minutes 53 seconds East 547.90 feet to an iron rod and cap (marked #7160), thence run South 27 degrees 30 minutes 19 seconds West 323.16 feet to an iron rod and cap (marked #7160), thence run South 86 degrees 01 minutes 16 seconds West 508.99 feet to the POINT OF BEGINNING containing 5.00 acres, more or less.

SUBJECT TO and together with a 20.00 foot wide ingress and egress easement lying 10.00 feet each side of the following described centerline:

Commence at the Southwest corner of Section 13, Township 7 South, Range 5 West, Franklin County, Florida and run North 1828.93 feet, thence run North 89 degrees 59 minutes 22 seconds East 2199.40 feet, thence run South 00 degrees 01 minutes 36 seconds West 487.98 feet to a point lying on the Northeasterly right-of-way boundary of a county graded dirt road, thence run South 58 degrees 03 minutes 12 seconds East along said right-of-way boundary 649.66 feet, to the POINT OF BEGINNING. From said POINT OF BEGINNING and leaving said right-of-way boundary run North 22 degrees 07 minutes 49 seconds East 222.78 feet, thence run North 57 degrees 05 minutes 24 seconds East 104.31 feet, thence run North 07 degrees 41 minutes 00 seconds East 92.00 feet, thence run North 47 degrees 59 minutes 30 seconds East 33.05 feet, thence run North 75 degrees 08 minutes 36 seconds East 31.44 feet, thence run South 84 degrees 37 minutes 40 seconds East 38.42 feet, thence run South 74 degrees 18 minutes 27 seconds East 48.31 feet, thence run North 87 degrees 19 minutes 52 seconds East 36.30 feet, thence run North 61 degrees 56 minutes 27 seconds East 34.66 feet, thence run North 39 degrees 50 minutes 34 seconds East 27.21 feet, thence run North 29 degrees 47 minutes 49 seconds East 185.59 feet, thence run North 15 degrees 04 minutes 05 seconds East 32.90 feet, thence run North 13 degrees 42 minutes 38 seconds West 30.94 feet, thence run North 26 degrees 07 minutes 24 seconds West 139.98 feet, thence run North 06 degrees 42 minutes 21 seconds West 37.03 feet, thence run North 20 degrees 05 minutes 56 seconds East 36.48 feet, thence run North 30 degrees 51 minutes 20 seconds East 101.68 feet, thence run North 17 degrees 33 minutes 40 seconds East 34.56 feet, thence run North 01 degrees 17 minutes 28 seconds East 43.20 feet, thence run North 05 degrees 08 minutes 04 seconds West 63.77 feet, thence run North 08 degrees 23 minutes 25 seconds East 43.39 feet, thence run North 15 degrees 34 minutes 47 seconds East 30.99 feet, thence run North 28 degrees 39 minutes 42 seconds East 56.45 feet, thence run North 42 degrees 51 minutes 26 seconds East 41.09 feet, thence run North 52 degrees 11 minutes 07 seconds East 27.38 feet, thence run North 60 degrees 34 minutes 52 seconds East 183.18 feet, thence run North 63 degrees 58 minutes 02 seconds East 54.92 feet, thence run North 67 degrees 15 minutes 33 seconds East 63.65 feet, thence run North 58 degrees 56 minutes 13 seconds East 48.43 feet, thence run North 40 degrees 26 minutes 43 seconds East 32.88 feet, thence run North 29 degrees 57 minutes 32 seconds East 225.11 feet, thence run North 23 degrees 37 minutes 08 seconds East 171.24 feet to the point of terminus.

Commence at the Southwest corner of Section 13, Township 7 South, Range 5 West, Franklin County, Florida and run North 1828.93 feet, thence run North 89 degrees 59 minutes 22 seconds East 2199.40 feet, thence run South 00 degrees 01 minutes 36 seconds West 487.98 feet to a point lying on the Northeasterly right-of-way boundary of a county graded dirt road, thence run South 58 degrees 03 minutes 12 seconds East along said right-of-way boundary 546.74 feet to a concrete monument (marked #4261), thence leaving said right-of-way boundary run North 15 degrees 42 minutes 24 seconds East 280.36 feet to an iron rod and cap (marked #7160) marking the POINT OF BEGINNING. From said POINT OF BEGINNING run North 15 degrees 42 minutes 24 seconds East 404.53 feet to an iron rod and cap (marked #7160), thence run North 86 degrees 01 minutes 16 seconds East 508.99 feet to an iron rod and cap (marked #7160), thence run South 27 degrees 30 minutes 19 seconds West 689.09 feet to iron rod and cap (marked #7160), thence run North 58 degrees 03 minutes 12 seconds West 352.40 feet to the POINT OF BEGINNING containing 5.00 acres, more or less.

SUBJECT TO and together with a 20.00 foot wide ingress and egress easement lying 10.00 feet each side of the following described centerline:

Commence at the Southwest corner of Section 13, Township 7 South, Range 5 West, Franklin County, Florida and run North 1828.93 feet, thence run North 89 degrees 59 minutes 22 seconds East 2199.40 feet, thence run South 00 degrees 01 minutes 36 seconds West 487.98 feet to a point lying on the Northeasterly right-of-way boundary of a county graded dirt road, thence run South 58 degrees 03 minutes 12 seconds East along said right-of-way boundary 649.66 feet, to the POINT OF BEGINNING. From said POINT OF BEGINNING and leaving said right-of-way boundary run North 22 degrees 07 minutes 49 seconds East 222.78 feet, thence run North 57 degrees 05 minutes 24 seconds East 104.81 feet, thence run North 07 degrees 41 minutes 00 seconds East 92.00 feet, thence run North 47 degrees 59 minutes 30 seconds East 33.05 feet, thence run North 75 degrees 08 minutes 36 seconds East 31.44 feet, thence run South 84 degrees 37 minutes 40 seconds East 38.42 feet, thence run South 74 degrees 18 minutes 27 seconds East 48.31 feet, thence run North 87 degrees 19 minutes 52 seconds East 36.30 feet, thence run North 61 degrees 56 minutes 27 seconds East 34.66 feet, thence run North 39 degrees 50 minutes 34 seconds East 27.21 feet, thence run North 29 degrees 47 minutes 49 seconds East 185.59 feet, thence run North 15 degrees 04 minutes 05 seconds East 32.90 feet, thence run North 13 degrees 42 minutes 38 seconds West 30.94 feet, thence run North 26 degrees 07 minutes 24 seconds West 139.98 feet, thence run North 06 degrees 42 minutes 21 seconds West 37.03 feet, thence run North 20 degrees 05 minutes 56 seconds East 36.48 feet, thence run North 30 degrees 51 minutes 20 seconds East 101.68 feet, thence run North 17 degrees 33 minutes 40 seconds East 34.56 feet, thence run North 01 degrees 17 minutes 28 seconds East 43.20 feet, thence run North 05 degrees 08 minutes 04 seconds West 63.77 feet, thence run North 08 degrees 23 minutes 25 seconds East 43.39 feet, thence run North 15 degrees 34 minutes 47 seconds East 30.99 feet, thence run North 28 degrees 39 minutes 42 seconds East 56.45 feet, thence run North 42 degrees 51 minutes 26 seconds East 41.09 feet, thence run North 52 degrees 11 minutes 07 seconds East 27.38 feet, thence run North 60 degrees 34 minutes 52 seconds East 183.18 feet, thence run North 63 degrees 58 minutes 02 seconds East 54.92 feet, thence run North 67 degrees 15 minutes 33 seconds East 63.65 feet, thence run North 58 degrees 56 minutes 13 seconds East 48.43 feet, thence run North 40 degrees 26 minutes 43 seconds East 32.88 feet, thence run North 29 degrees 57 minutes 32 seconds East 225.11 feet, thence run North 23 degrees 37 minutes 08 seconds East 171.24 feet to the point of terminus.

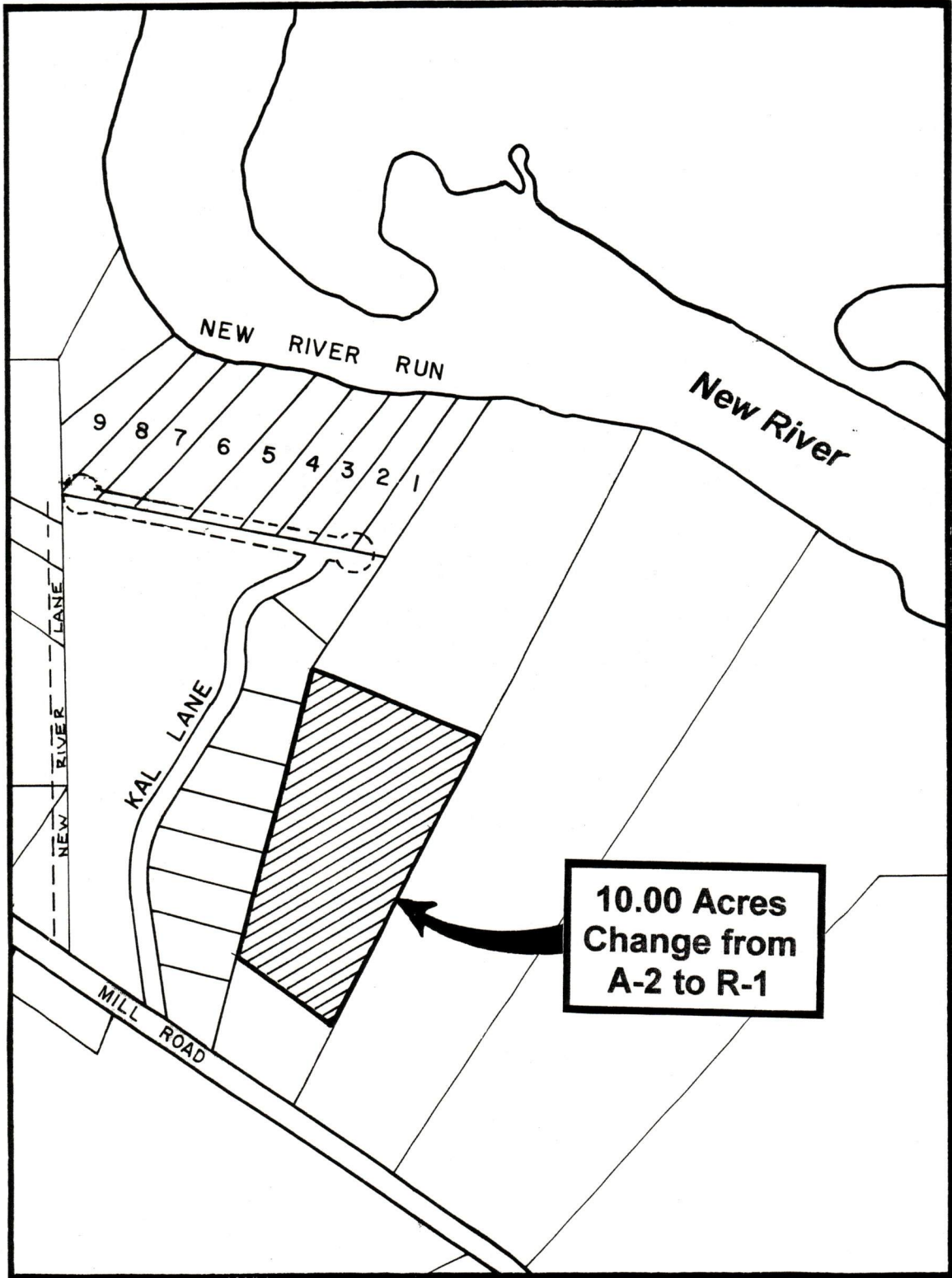

**10.00 Acres
Change from
A-2 to R-1**