

**AN ORDINANCE REZONING A 9.05 ACRE PARCEL LYING IN SECTION 13, TOWNSHIP 7 SOUTH, RANGE 5 WEST, NORTHWEST OF CARRABELLE, FRANKLIN COUNTY, FLORIDA FROM A-2 FORESTRY AGRICULTURE TO R-1 SINGLE FAMILY RESIDENTIAL.**

**ORDINANCE 2004- 11  
FRANKLIN COUNTY, FLORIDA**

WHEREAS, the Board of County Commissioners of Franklin County, Florida has received a recommendation from the Franklin County Planning and Zoning Commission for rezoning certain private real property, and

WHEREAS, the Board of County Commissioners of Franklin County has conducted a public hearing with due public notice,

NOW, THEREFORE, BE IT ORDAINED BY THE FRANKLIN COUNTY BOARD OF COUNTY COMMISSIONERS that:

Legal Description attached as Exhibit B. A 9.05 acre parcel lying in Section 13, Township 7 South, Range 5 West, northwest of Carrabelle, Franklin County, Florida, is rezoned from A-2 Forestry Agriculture to R-1 Single Family Residential.

This Ordinance adopted this 20 day of April, 2004, in a regular meeting of the Franklin County Board of County Commissioners after giving notice of intent to adopt it as a rezoning of less than 5% of the County. This Ordinance shall take effect when notice of receipt of a certified copy of same is returned from the Florida Secretary of State

THE FRANKLIN COUNTY BOARD  
OF COUNTY COMMISSIONERS

BY: 

Cheryl Sanders, Chairman

ATTEST: 

Kendall Wade, Clerk

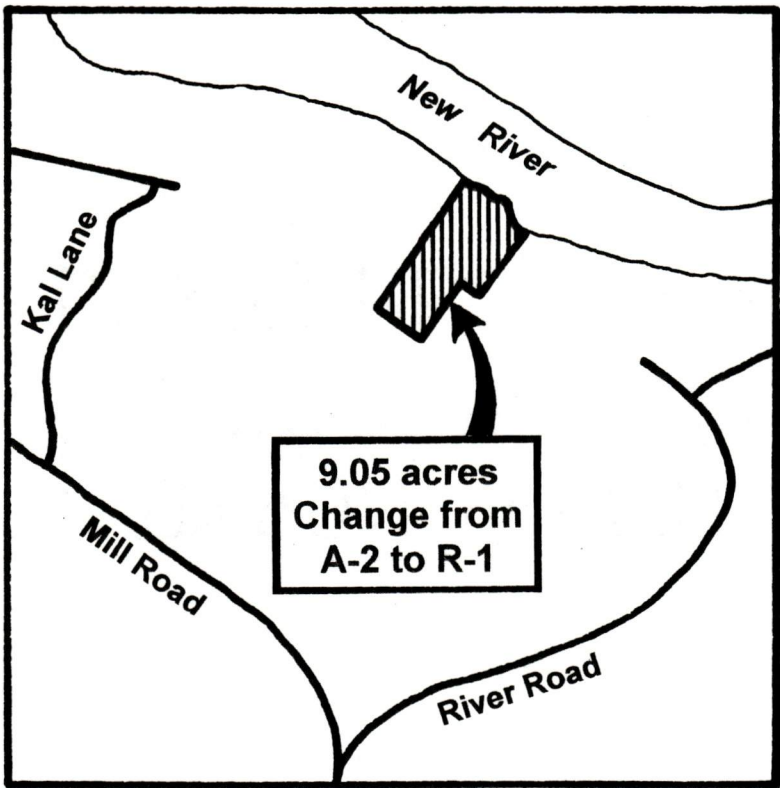

EXHIBIT B

Commence at a concrete monument (marked "BCC") marking the Southwest corner of Section 13, Township 7 South, Range 5 West, Franklin County, Florida and proceed North along the West boundary of said Section 13 a distance of 1828.93 feet to a concrete monument (marked "BCC"), thence run North 09 degrees 59 minutes 22 seconds East 2199.40 feet to a concrete monument (marked "BCC"), thence South 00 degrees 01 minutes 36 seconds West 487.98 feet to a concrete monument (marked "BCC") on the Northeastly right-of-way boundary of a 40.00 foot wide County Road, thence run South 58 degrees 03 minutes 12 seconds East along said Northeastly right-of-way boundary 1136.40 feet to a concrete monument (marked #4261) and marking the POINT OF BEGINNING. From said POINT OF BEGINNING thence run North 33 degrees 02 minutes 23 seconds East 2428.19 feet to the water's edge of New River, thence run along said water's edge the following 7 courses and distances: South 53 degrees 40 minutes 03 seconds East 320.58 feet, thence South 46 degrees 31 minutes 26 seconds East 106.10 feet, thence South 05 degrees 17 minutes 54 seconds East 26.04 feet, thence South 32 degrees 31 minutes 20 seconds West 20.05 feet, thence South 04 degrees 42 minutes 08 seconds West 40.15 feet, thence South 04 degrees 32 minutes 38 seconds East 46.25 feet, thence South 61 degrees 11 minutes 09 seconds East 505.75 feet, thence leaving said water's edge run South 00 degrees 03 minutes 22 seconds East 500.00 feet to a concrete monument (marked #4261), thence run West 477.85 feet to a concrete monument (marked #4261), thence run South 43 degrees 40 minutes 23 seconds West 1672.79 feet to a concrete monument (marked #4261) on said Northeastly right-of-way boundary, thence run North 58 degrees 03 minutes 12 seconds West along said Northeastly right-of-way boundary 570.79 feet to the POINT OF BEGINNING.

FL 921360 B 375 P 119  
CO:FRANKLIN ST:FL