

AN ORDINANCE AMENDING THE FRANKLIN COUNTY COMPREHENSIVE PLAN TO CHANGE THE PERMITTED LAND USE OF LOT 13 OF EMERALD POINT BEACH IN SECTION 24, TOWNSHIP 8 SOUTH, RANGE 6 WEST, FROM RURAL RESIDENTIAL TO RESIDENTIAL.

**ORDINANCE 2000- 25
FRANKLIN COUNTY, FLORIDA**

WHEREAS, the Board of County Commissioners of Franklin County, Florida has received a recommendation from the Franklin County Planning and Zoning Commission for changing the land use of a certain parcel of private real property, and

WHEREAS, the Board of County Commissioners of Franklin County has conducted a public hearing with due public notice,

NOW, THEREFORE, BE IT ORDAINED BY THE FRANKLIN COUNTY BOARD OF COUNTY COMMISSIONERS that:

The permitted land use of Lot 13 of the unrecorded plat of Emerald Point Beach, as described below, as shown on the attached map, is changed from Rural Residential to Residential.

Commence at a concrete monument marking the Northwest corner of Section 24, also being the Northeast corner of Section 23, Township 8 South, Range 6 West, Franklin County, Florida and thence run North 89 degrees 22 minutes 40 seconds West along the North boundary of said Section 23 a distance of 3234.43 feet to a concrete monument, thence run South 00 degrees 26 minutes 10 seconds West 1708.34 feet to a concrete monument lying on the Northerly right-of-way boundary of a 100.00 foot Florida Power Corporation powerline easement, thence run North 69 degrees 11 minutes 43 seconds East along said right-of-way boundary 4158.70 feet to the POINT OF BEGINNING. From said POINT OF BEGINNING run North 57 degrees 36 minutes 36 seconds East along said right-of-way boundary 115.00 feet, thence leaving said right-of-way boundary run South 55 degrees 24 minutes 13 seconds East 927.95 feet to the Northerly right-of-way boundary of U.S. Highway 98 said point lying on a curve concave to the Northwesterly, thence run Southwesterly along said right-of-way boundary and curve with a radius of 1660.72 feet through a central angle of 13 degrees 08 minutes 20 seconds for an arc distance 380.83 feet to a point of tangency, thence run South 87 degrees 33 minutes 46 seconds West along said right-of-way boundary 196.72 feet, thence leaving said right-of-way boundary run North 28 degrees 28 minutes 15 seconds West 606.48 feet to the POINT OF BEGINNING.

ALSO:

Commence at the above mentioned POINT OF BEGINNING and run South 28 degrees 28 minutes 15 seconds East 679.93 feet to a point lying on the Southerly right-of-way boundary of U.S. Highway No. 98 and marking the POINT OF BEGINNING. From said POINT OF BEGINNING run North 87 degrees 33 minutes 46 seconds East along said right-of-way boundary 164.48 feet to a point of curve to the left, thence run Northeasterly along said right-of-way boundary and curve with a radius of 1726.72 feet through a central angle of 14 degrees 56 minutes 31 seconds for an arc distance of 450.30 feet, thence leaving said right-of-way boundary run South 55 degrees 24 minutes 13 seconds East 12.71 feet to the approximate mean high water line of St. George Sound, thence run Southwesterly along said mean high water line the following three courses: South 77 degrees 22 minutes 04 seconds West 322.64 feet, South 81 degrees 54 minutes 29 seconds West 174.96 feet, South 76 degrees 41 minutes 51 seconds West 108.61 feet, thence leaving said mean high water line run North 28 degrees 28 minutes 15 seconds West 49.07 feet to the POINT OF BEGINNING.

This Ordinance adopted this 7th day of November, 2000, in a regular meeting of the Franklin County Board of County Commissioners after notice was duly given, and pursuant to Chapter 163, Florida Statutes.

THE FRANKLIN COUNTY BOARD OF
COUNTY COMMISSIONERS

BY: Clarence Williams
Clarence Williams, Chairman

ATTEST:

Kendall Wade
Kendall Wade, Clerk



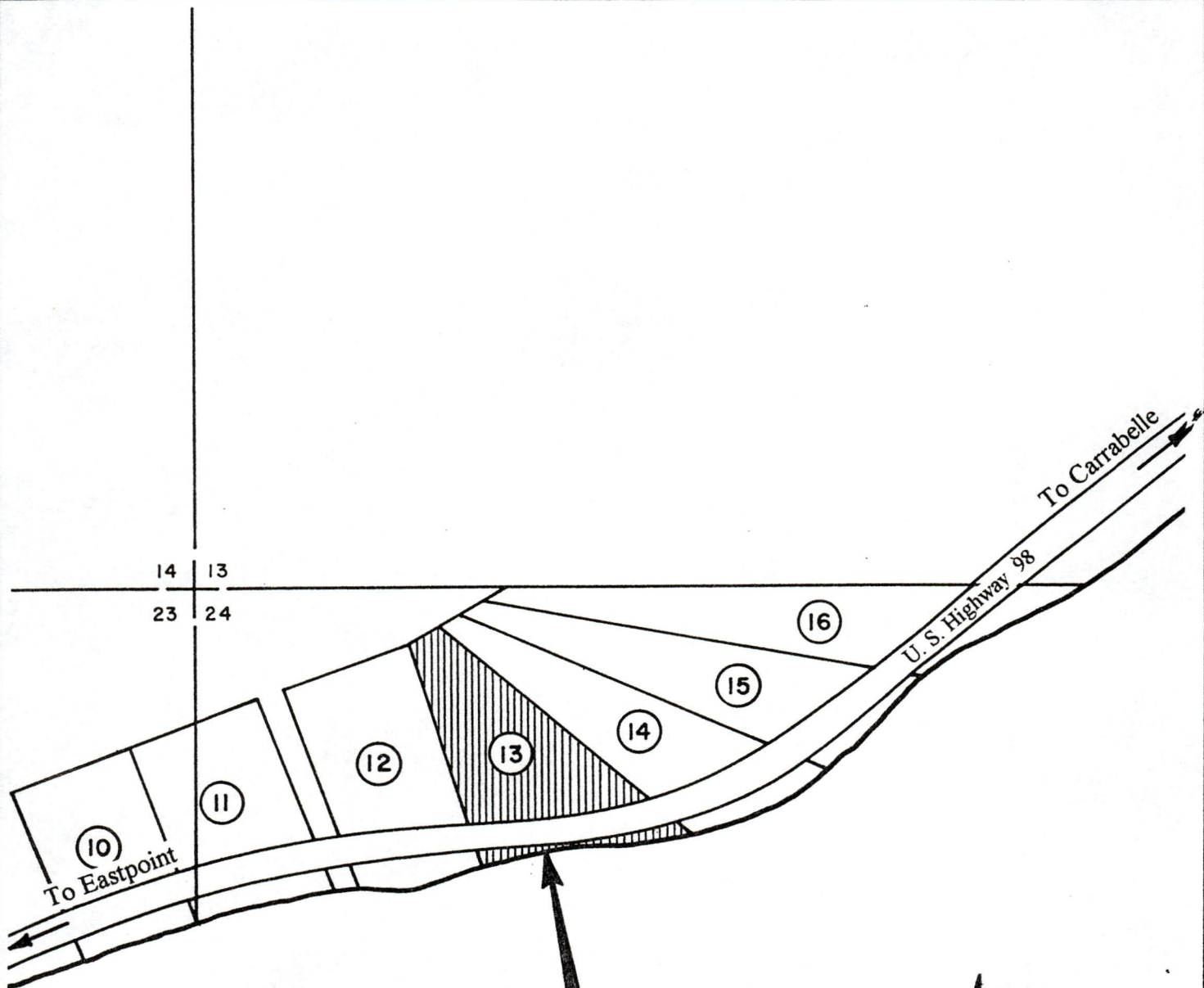

**CHANGE FROM
RURAL RESIDENTIAL
TO
RESIDENTIAL**

GULF OF MEXICO

SCALE 1" = 500'		SHEET
DATE		OF